

P300 SERIES PARTS LIST

A= P317 B= P323 C= P340 D= P316 E= P322 F= P319 G= P325 H= P328 I= P329 J=P332

<u>ITEM</u>	<u>PART #</u>	<u>DESCRIPTION</u>	<u>QTY.</u>	<u>ITEM</u>	<u>PART #</u>	<u>DESCRIPTION</u>	<u>QTY.</u>
1	08326	Crankcase	1	17	06542	Wrist Pin	3
2	06773	Dipstick Assembly	1	17A	22723	Clip Ring	6
3	08410B	Crankcase Cover, Short	1	18	07770	O-Ring	3
3	08410-LG	Crankcase Cover, Extended	1	19	08356	Oil Seal	3
3A	07190	Oil Drain Plug	1	20	08458	Seal Case (A,B,D,E,F,G,J)	3
3B	13262A	Gasket for Plug	1	20	06543	Seal Case (C,H,I)	3
4	08328	O-Ring	1	21	07780	O-Ring	3
5	06273	Oil Drain Plug	1	22	12027	O-Ring	3
5A	08192	Gasket	1	23	08477	V-Sleeve (A,B,D,E,F,G,J)	3
6	07188	Screw, Short Cover	4	23	07767	Grooved Seal (C,H,I)	3
6A	01176-2	Spring Washer	12	23A	08087	Grooved Seal (A,B,D,E,F,G,J)	3
6B	01196	Screw, Long Cover	4	23A	06315	Grooved Seal (C,H,I)	3
7	08303	Bearing Cover I	2	24	07904	Pressure Ring (A,B,D,E,F,G,J)	6
8	08491	Sight Glass	1	24	07768	Pressure Ring (C,H,I)	3
9	07193	O-Ring	1	25	08337	Weep Return Ring	
10	07225	Screw with Lock Washer	8			(A,B,D,E,F,G)	3
11	08331	Radial Shaft Seal	1	25	06544	Weep Return Ring (C,H,I)	3
12	01086	Ball Bearing (A,D,F,H)	2	26	06349*	Valve Casing (A,B,D,E,F,G,J)	1
12	01086A	Ball Bearing (B,C,E,G,I,J)	1	26	06545	Valve Casing (C,H,I)	1
12A	07760	Roller Bearing (B,C,E,G,I,J)	1	27	07849	Valve Seat	6
13	08478	Crankshaft (A,B)	1	28	07491	Valve Plate	6
13	08332	Crankshaft (C,D,E,)	1	29	07906	Valve Spring	6
13	06508	Crankshaft (F,G,H,I)	1	30	07907	Valve Spring Retainer	6
13	08340	Crankshaft (J)	1	31	07853	O-Ring	6
14	06207	Straight Key	1	32	06350*	Valve Plug (A,B,D,E,F,G,J)	6
15	08333	Connecting Rod	3	32	06546	Valve Plug (C,H,I)	6
16	08453	Plunger Assembly Complete, 18mm (A,B,D,E,F,G,J)	3	32X	07946A	Valve Assembly, Complete	6
16	06540	Plunger Assembly, Complete, 16mm (C,H,I)	3	33	07913	O-Ring	6
16A	08367	Plunger Base	3	34	08363	Hex Head Cap Screw	6
16B	08455	Plunger Pipe (A,B,D,E,F,G,J)	3	36	13338	Plug, 3/8" BSP	1
16B	06541	Plunger Pipe (C,H,I)	3	36A	08486	Copper Crush Washer, 3/8"	1
16C	08456	Tension Screw	3	37	07109	Plug, 1/2" BSP	1
16D	07676	Copper Washer	3	37A	07661	Seal	1

*For P316/P317 pumps manufactured prior to 5/98, Item 26=08459 & Item 32=07928

P300 SERIES REPAIR KITS

Plunger Packing Kits

P316/P317/P319/P322/

P323/P325/P332 - # 09119

Item	Part #	Description	Qty.
23	08477	Grooved Seal, Black	3
23A	08087	Grooved Seal, Brown	3
24	07904	Pressure Ring, 18mm	6

P328/P329/P340 - # 09507

Item	Part #	Description	Qty.
23	07767	Grooved Seal, 16mm	3
23A	06315	Grooved Seal, 16mm	3
24	07768	Pressure Ring	3

Valve Assembly Kit - # 09116

Item	Part #	Description	Qty.
31	07853	O-Ring	6
32X	07946A	Valve Assembly	6
33	07913	O-Ring	6

Oil Seal Kit - # 09144

Item	Part #	Description	Qty.
19	08356	Oil Seal	3

Optional Viton Seal Kits

P316/P317/P319/P322/P323/P325 - # 09456

Item	Part #	Description	Qty.
18	07770-0001	O-Ring, Viton	3
21	07780-0001	O-Ring, Viton	3
22	12027-0001	O-Ring, Viton	3
23/23A	07902-0010	V-Sleeve, Viton	6
24	07904	Pressure Ring	6
31	07853-0001	O-Ring, Viton	6
33	07913-0001	O-Ring, Viton	6

Optional High-Temp Seal Kits

P316/P317/P319/P322/P323/P325 - # 09599

Item	Part #	Description	Qty.
23/23A	08477-0030	High-Temp Seals	6
24	07904	Pressure Ring	6

Torque Specifications

Position	Item #	Description	Torque Amount
3A	07190	Oil Drain Plug w/ Gasket	266 in.-lbs. (30 Nm)
5	06273	Oil Drain Plug	266 in.-lbs. (30 Nm)
6/6B	07188/01196	Screw	88 in.-lbs. (10 Nm)
10	07225	Screw with Lock Washer	88 in.-lbs. (10 Nm)
16C	08450	Tension Screw, Plunger	200 in.-lbs. (22.5 Nm)
32	06350/06546	Plug	55 ft.-lbs. (75 Nm)
34	08363	Hex Head Cap Screw, Valve Casing	221 in.-lbs. (25 Nm)

Pump Mounting Selection Guide

<p>Bushings 01074 - 24 mm Tapered H Bushing</p>	<p>Rails 01160 Plated Steel Channel Rails (L=5.75" X W=1.0" x H+1.812") 01161 Plated Steel Channel Rails (L+5.75" x W+1.00" x H=2.50") 01163 Retro-Fit Rail (L=12" x W=1.5" x H=3")</p>
<p>Pulley & Sheaves 01061 - 7.75" Cast Iron 1 gr. - AB Section 01062 - 7.75" Cast Iron - 2 gr. - AB Section</p>	

Extended Crankcase

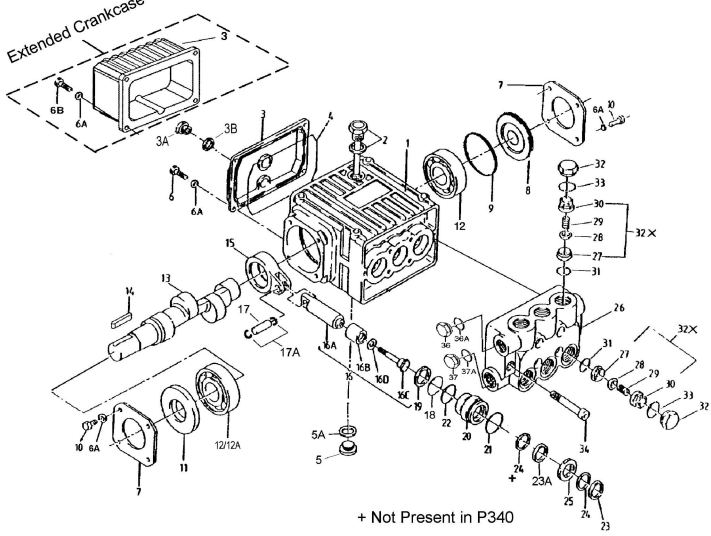

+ Not Present in P340